

Item 01 - Armário aéreo , 4 portas

Armário aéreo em MDF ou MDP - 7und

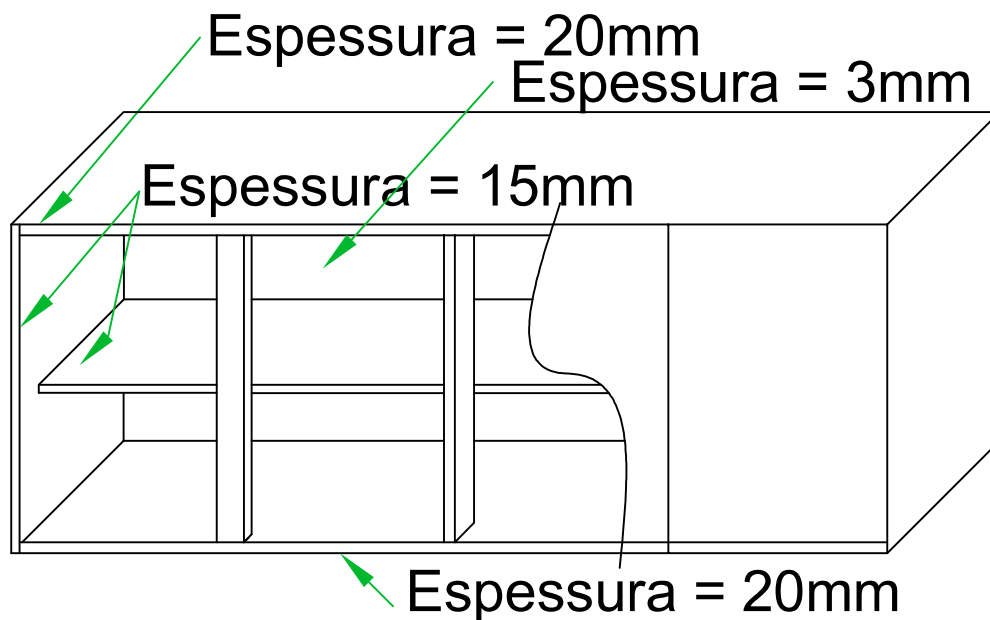
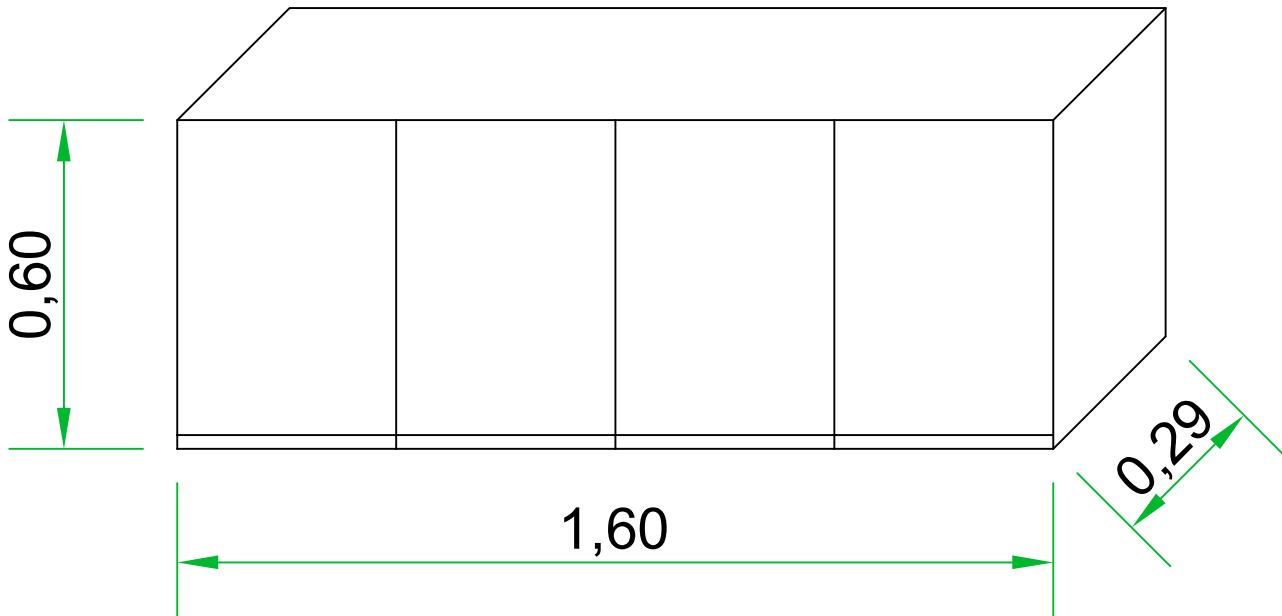

Unidade de medida metro

Item 20 - Estante MDF 2X1,70

Estante em MDF ou MDP - 1und

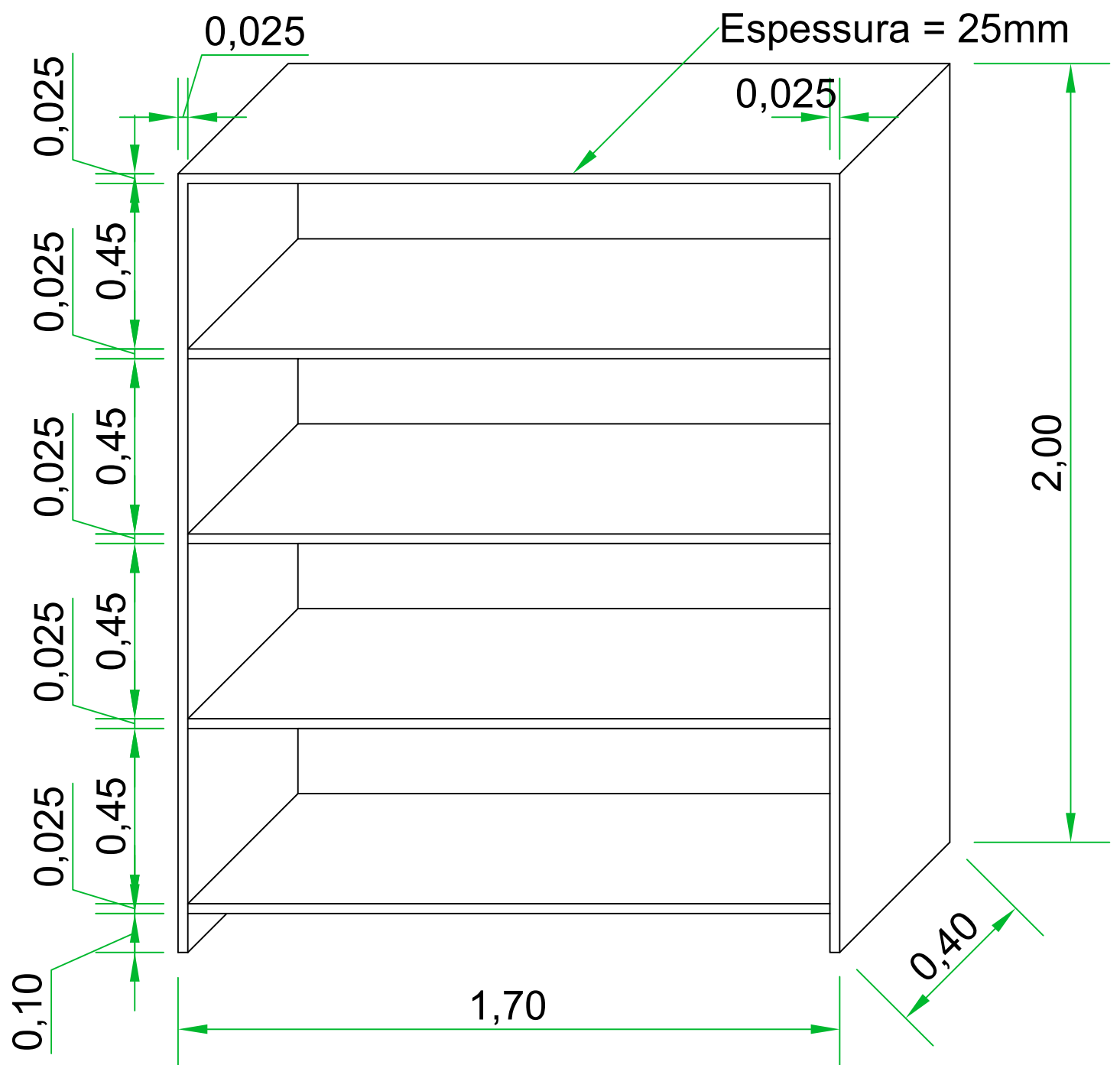

Unidade de medida metro

Item 19 - Estante MDF 2X1,10

Estante em MDF ou MDP - 1und

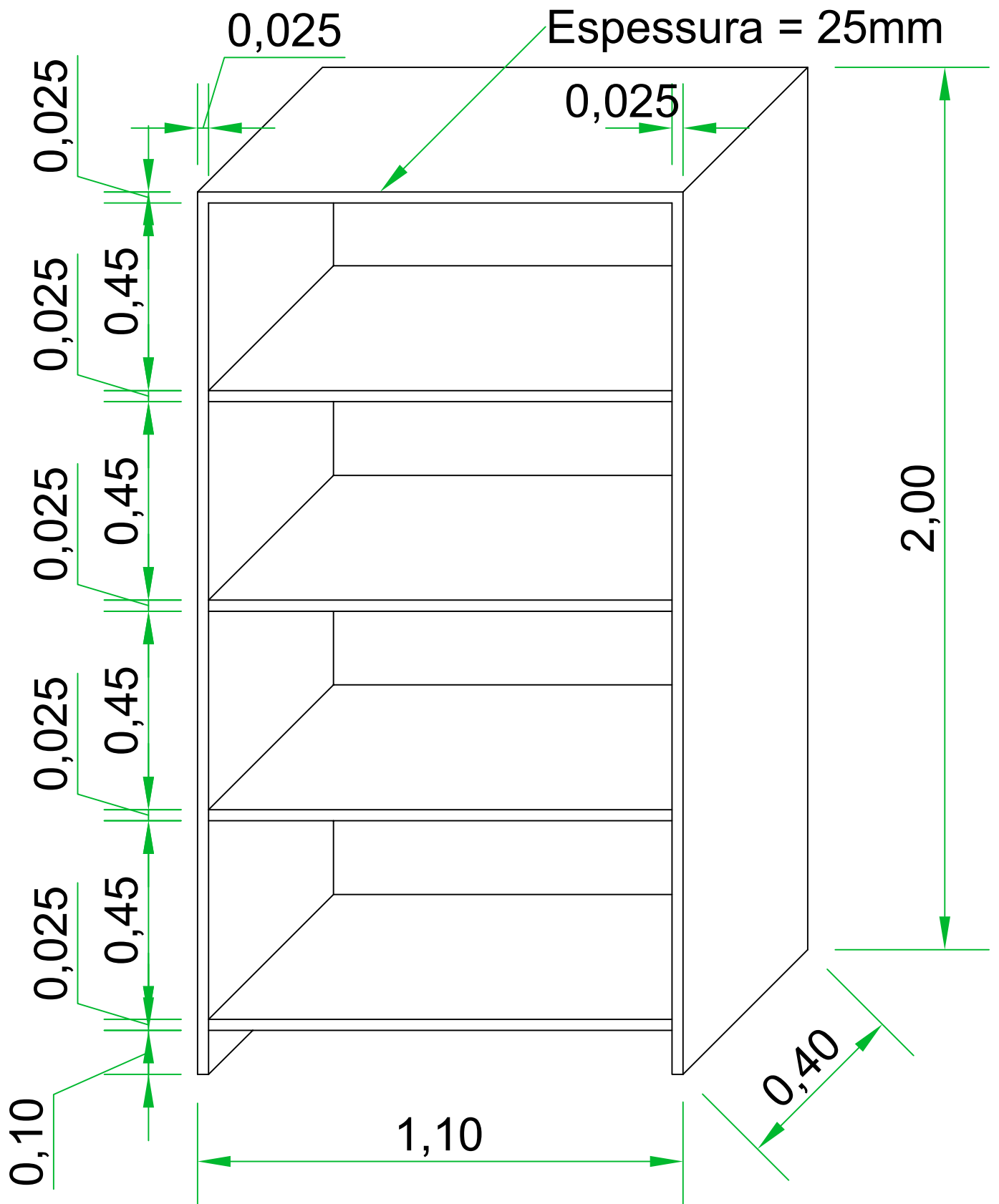

Unidade de medida metro

Coloque apenas um
livro por vez

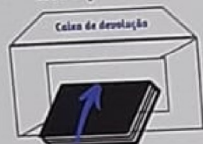

Item 10 - Carrinho para autodevolução de livros

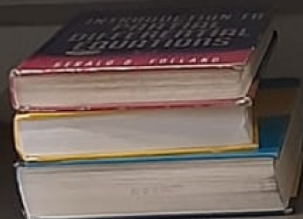

Item 10 - Carrinho para autodevolução de livros

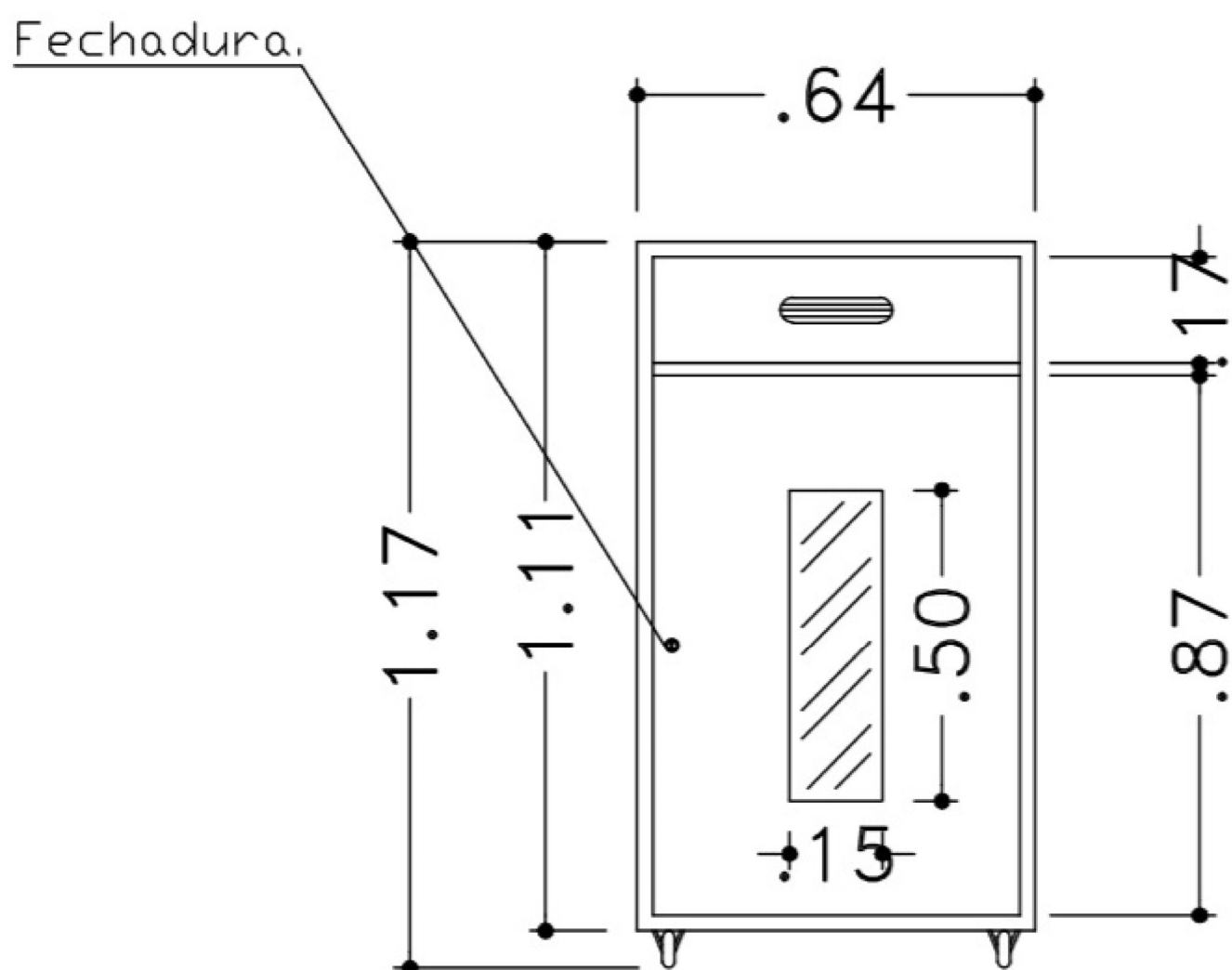

Item 18 - Estante manual tipo porta-palle's leve com plano metálico

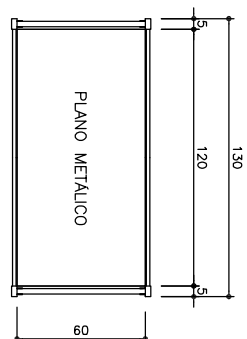

VISTA SUPERIOR
ESC: 1/25

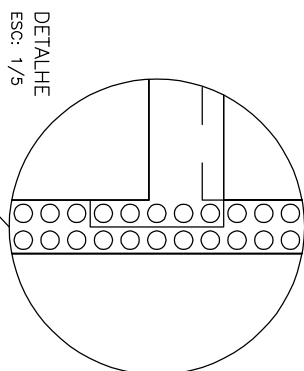

DETAILHE
ESC: 1/5

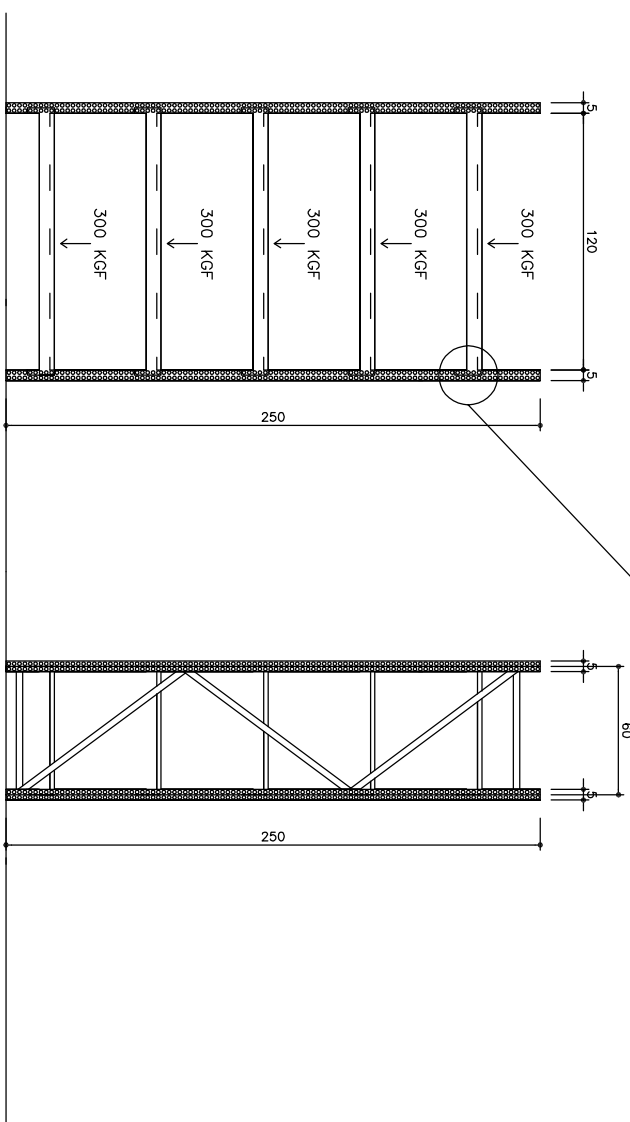

VISTA FRONTAL
ESC: 1/25

VISTA LATERAL
ESC: 1/25

[illegible]

Technical drawing of a rectangular frame. The overall width is 100 and the overall height is 246. The central opening is labeled "VAZIO". The dimensions of the central opening are 230 in width and 230 in height. The frame has a thickness of 8 on all sides.

Technical drawing of a rectangular frame. The overall dimensions are 300 (width) and 246 (height). The frame consists of two vertical sections and two horizontal sections. The vertical sections are 230 units wide, and the horizontal sections are 8 units high. The weight of the vertical sections is 2400 KG each, indicated by arrows pointing to them. The weight of the horizontal sections is 8 KG each, indicated by arrows pointing to them. A circular detail is shown at the bottom right corner of the frame.

Technical drawing of a truss structure. The structure is a triangular truss with a total width of 300 and a total height of 100. The top and bottom chords are composed of horizontal members, each with a thickness of 8. The vertical height is 100. The truss is supported by a vertical member on the left and a vertical member on the right. The internal members are diagonal members connecting the top and bottom chords. The drawing shows the truss structure with dimensions and a scale of 1:1.

[illegible]



Emitido em 08/08/2022

F0064 - DOCUMENTO DE LICITAÇÃO Nº 3/2022 - COMP - CL (10.38.05.08)

(Nº do Protocolo: NÃO PROTOCOLADO)

(Assinado digitalmente em 09/08/2022 09:05)

LUANA INES DAMKE

CHEFE - TITULAR

ASSGAS - CL (10.38.05.03)

Matrícula: 1807713

(Assinado digitalmente em 09/08/2022 09:10)

MARIA GORETI FINKLER

ASSISTENTE EM ADMINISTRACAO

ASSGAS - CL (10.38.05.03)

Matrícula: 1892262

Para verificar a autenticidade deste documento entre em <https://sipac.uffs.edu.br/documentos/> informando seu número: **3**, ano: **2022**, tipo: **F0064 - DOCUMENTO DE LICITAÇÃO**, data de emissão: **08/08/2022** e o código de verificação: **0d75117801**